



## **S221 NTLW**

High power, vented Subwoofer

2 x 21NTLW5000



# S221 NTLW | SPEAKERS

## 21NTLW5000 8Ω

### SPECIFICATIONS

Nominal Diameter	533 mm (21 in)
Nominal Impedance	8 Ω
Minimum Impedance	6.8 Ω
Nominal Power Handling <sup>1</sup>	1800 W
Continuous Power Handling <sup>2</sup>	4000 W
Sensitivity <sup>3</sup>	97.0 dB
Frequency Range	30 - 1800 Hz
Voice Coil Diameter	115 mm (4.5 in)

### KEY FEATURES

- 96,5 dB SPL 1W/1m average sensitivity
- Dual 115mm (4,5 in) Tetracoil Aluminum Voice coil
- 4000 W program power handling
- Ultra linear suspension behavior for excellent sound clarity
- Symmetric flux density and inductance behaviour
- Low noise forced air cooling design
- Water repellent cone and epoxy coated plates
- Suitable for vented, horn loaded and bandpass applications



### PARAMETERS<sup>4</sup>

Resonance Frequency	31 Hz
Re	5.3 Ω
Qes	0.38
Qms	5.2
Qts	0.36
Vas	270.0 dm <sup>3</sup> (9.53 ft <sup>3</sup> )
Sd	1662.0 cm <sup>2</sup> (257.61 in <sup>2</sup> )
Xmax	17.5 mm
Mms	372.0 g
Bl	32.0 Txm
Le	1.6 mH
EBP	81 Hz

### DESIGN

Magnet Material	Neo
Recommended Enclosure	200.0 dm <sup>3</sup> (7.06 ft <sup>3</sup> )
Recommended Tuning	33 Hz

### MOUNTING AND SHIPPING INFO

Overall Diameter	545 mm (21.46 in)
Bolt Circle Diameter	520 mm (20.47 in)
Baffle Cutout Diameter	492.0 mm (19.37 in)
Depth	320 mm (12.6 in)
Flange and Gasket Thickness	18 mm (0.71 in)
Net Weight	12.5 kg (27.56 lb)
Shipping Weight	13.5 kg (29.76 lb)
Shipping Box	570x570x350 mm (22.44x22.44x13.78 in)

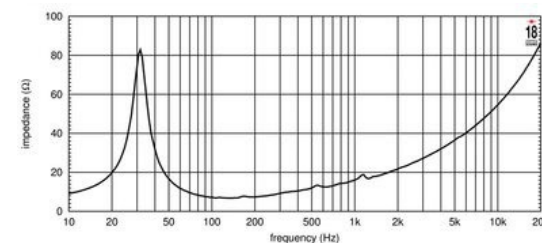
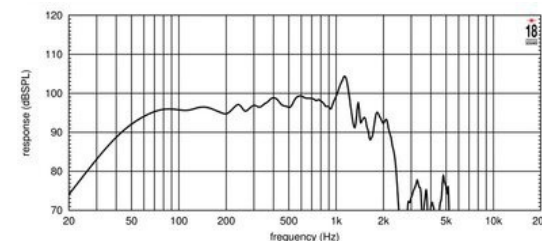

1. 2 hours test made with continuous pink noise signal within the range Fs-10Fs. Power calculated on rated minimum impedance. Loudspeaker in free air.  
 2. Power on Continuous Program is defined as 3 dB greater than the Nominal rating.  
 3. Applied RMS Voltage is set to 2.83 V for 8 ohms Nominal Impedance.  
 4. Thiele-Small parameters are measured after a high level 20 Hz sine wave preconditioning test.



## **S221 NTLW** | BILL OF MATERIALS

- 2x 21NTLW5000 – 8Ω
- 16x M8 Wood T-Nuts
- 16x M8 Hex socket head ISO 4762 with washer and grower washer
- 2x Neutrik NL4MPR
- Edilfiber damping material 30mm - 30kg/m<sup>3</sup>



# S221 NTLW | FREQUENCY RESPONSE IMPEDANCE RESPONSE

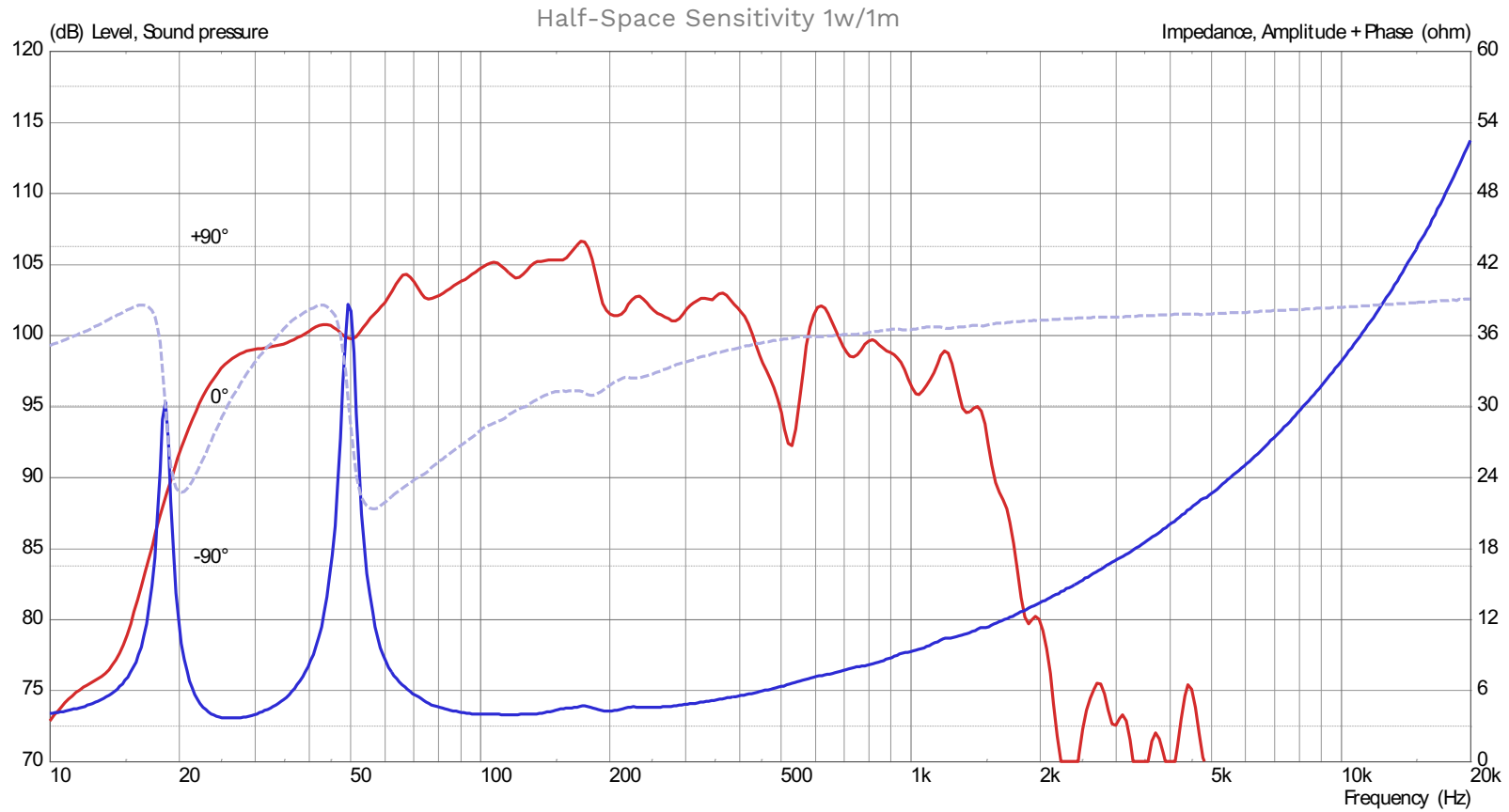



# S221 NTLW | CEA2010B

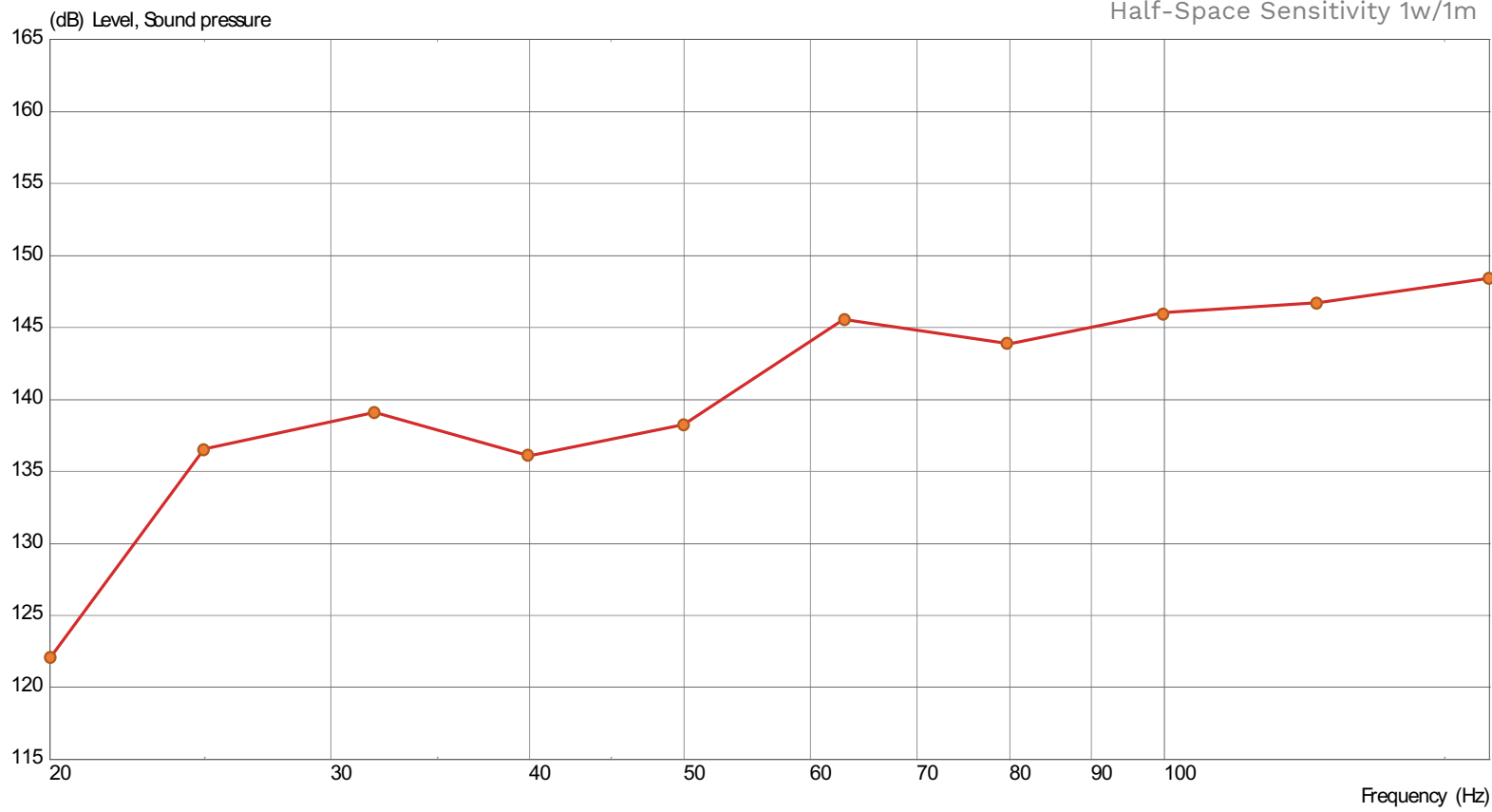

Tone Burst Center Frequency (Hz)	Weighted & Limited Maximum SPL (dB)
20	119
25	135
32	138
40	136
50	138
63	144
80	144
100	144
125	144
160	144



# S221 NTLW | PROCESSING

Equalization curve

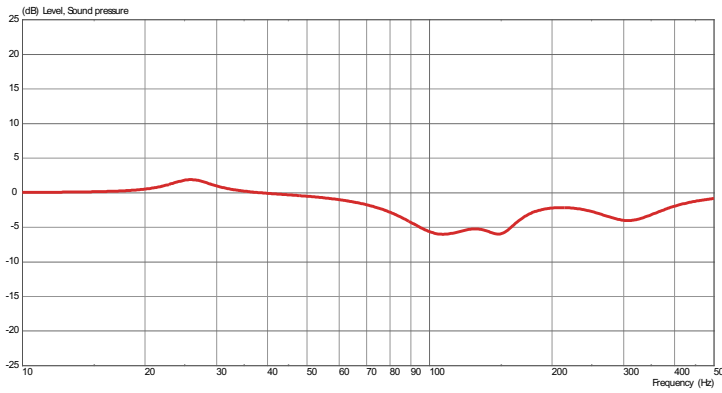

Equalization points:  
Pk: Frq: 26Hz - Q:3 - Gain: 2dB  
Pk: Frq: 106Hz - Q:1.8 - Gain: -5.5dB  
Pk: Frq: 150 - Q:4 - Gain: -3.5dB  
Pk: Frq: 310Hz - Q:2 - Gain: -3.7dB

Equalization curve with HPF & LPF

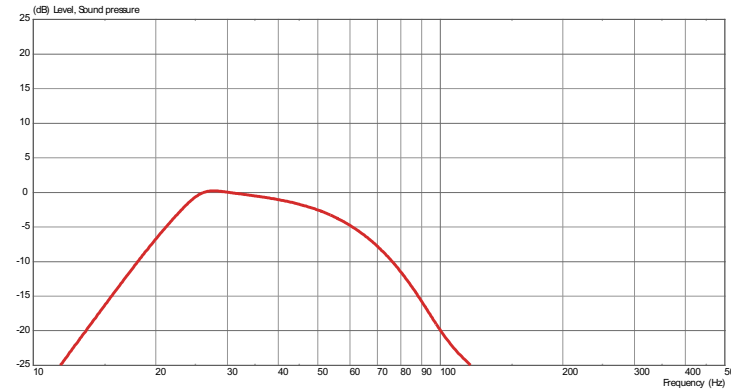

HPF:  
BTW 24dB/oct @ 24Hz

LPF:  
LR 24dB/oct @ 70Hz

Subwoofer response

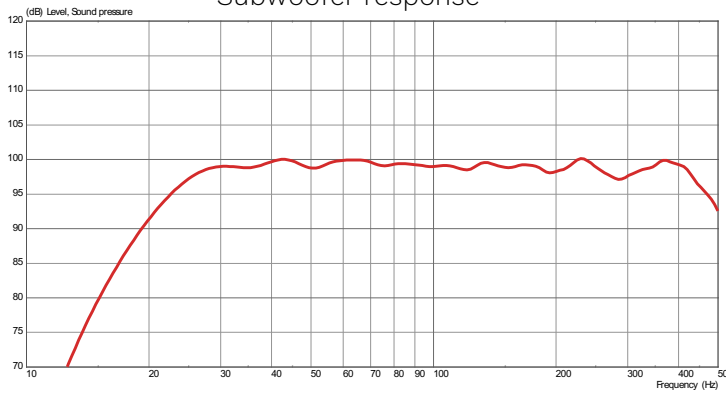

Subwoofer response

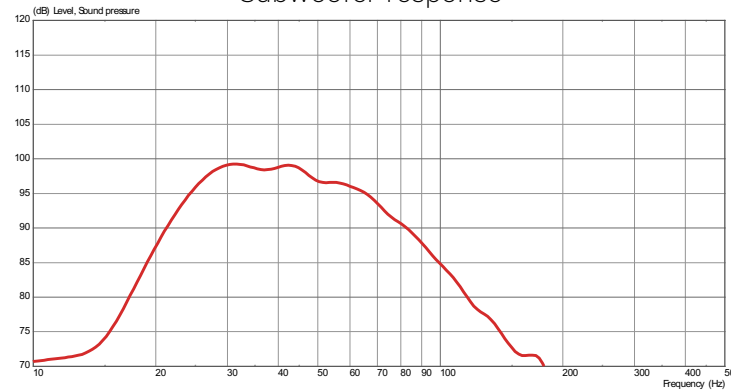



# **S221 NTLW**

Assembly Information



# S221 NTLW | DAMPING MATERIAL

Edilfiber (Polyester) 30kg/m<sup>3</sup> – 30mm thick

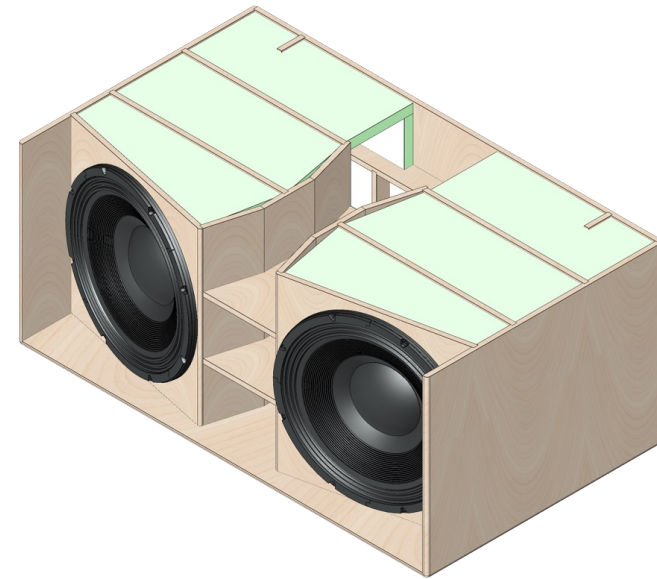
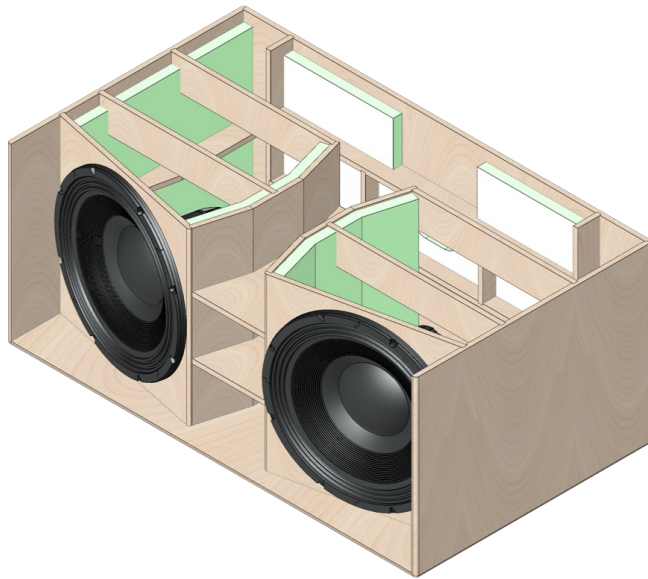

Follow carefully the quantity and positioning





# S221 NTLW | DAMPING MATERIAL

Edilfiber (Polyester) 30kg/m<sup>3</sup> – 30mm thick

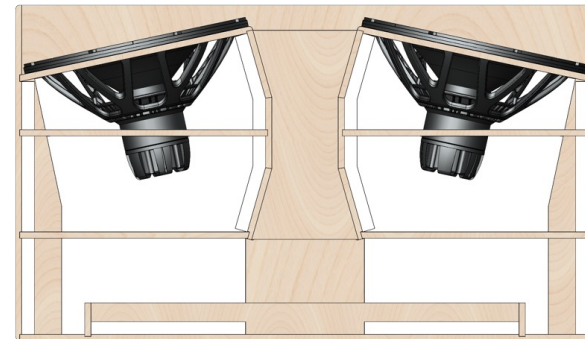
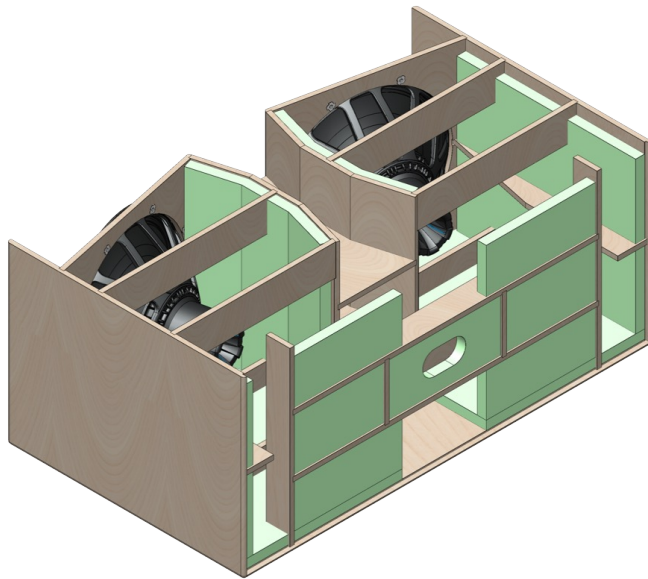

Follow carefully the quantity and positioning



# S221 NTLW | DIMENSIONS

Total dimensions

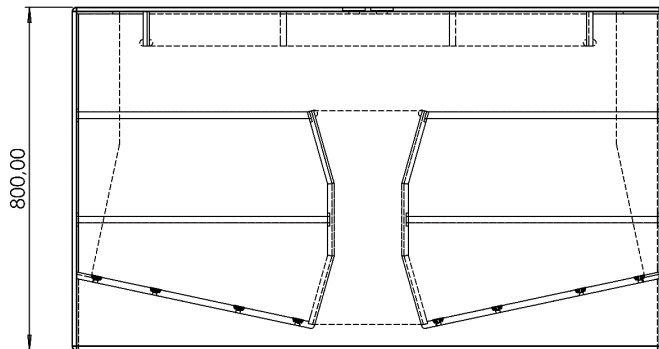
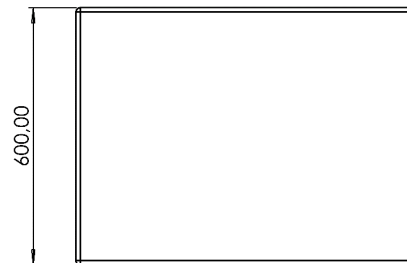
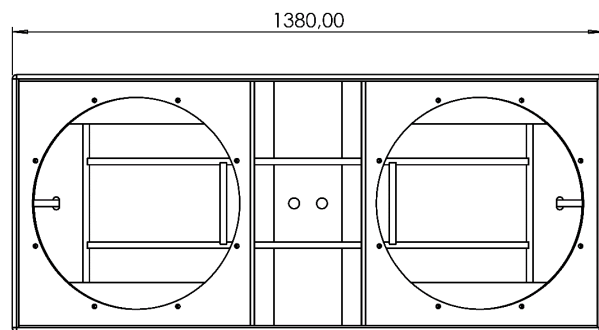

Material: 15mm birch plywood



# S221 NTLW | DIMENSIONS

Top View

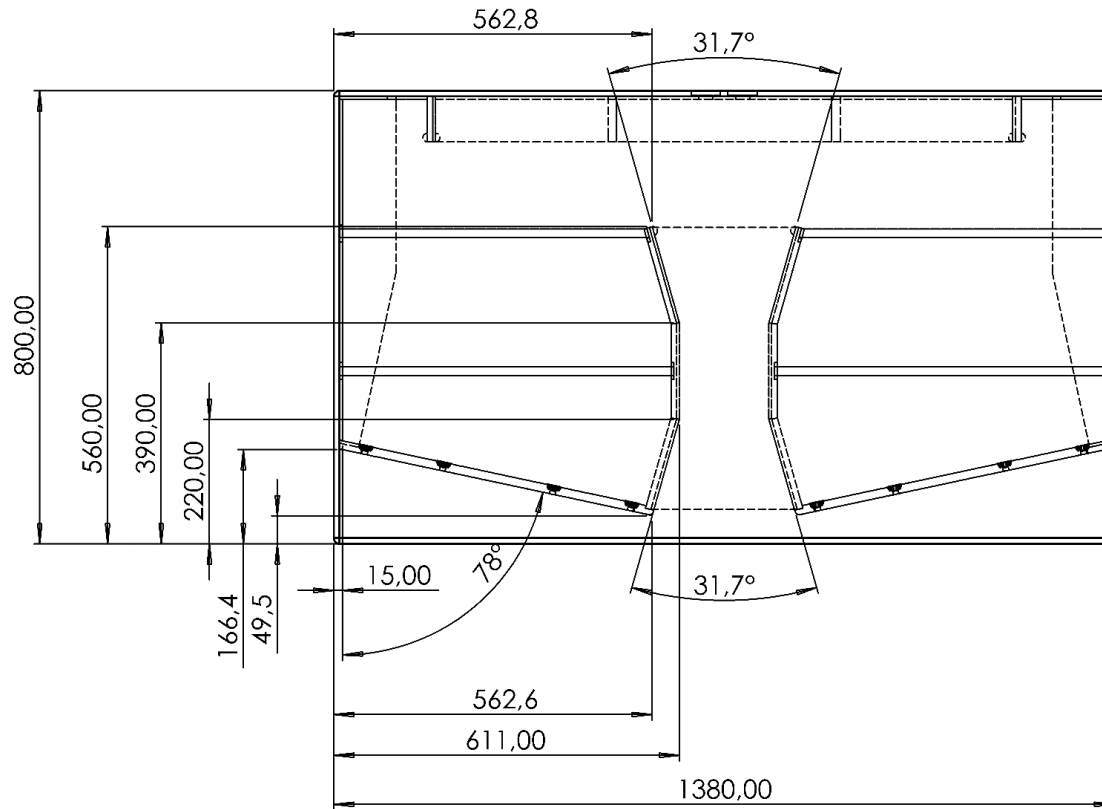



# S221 NTLW | DIMENSIONS

Top View

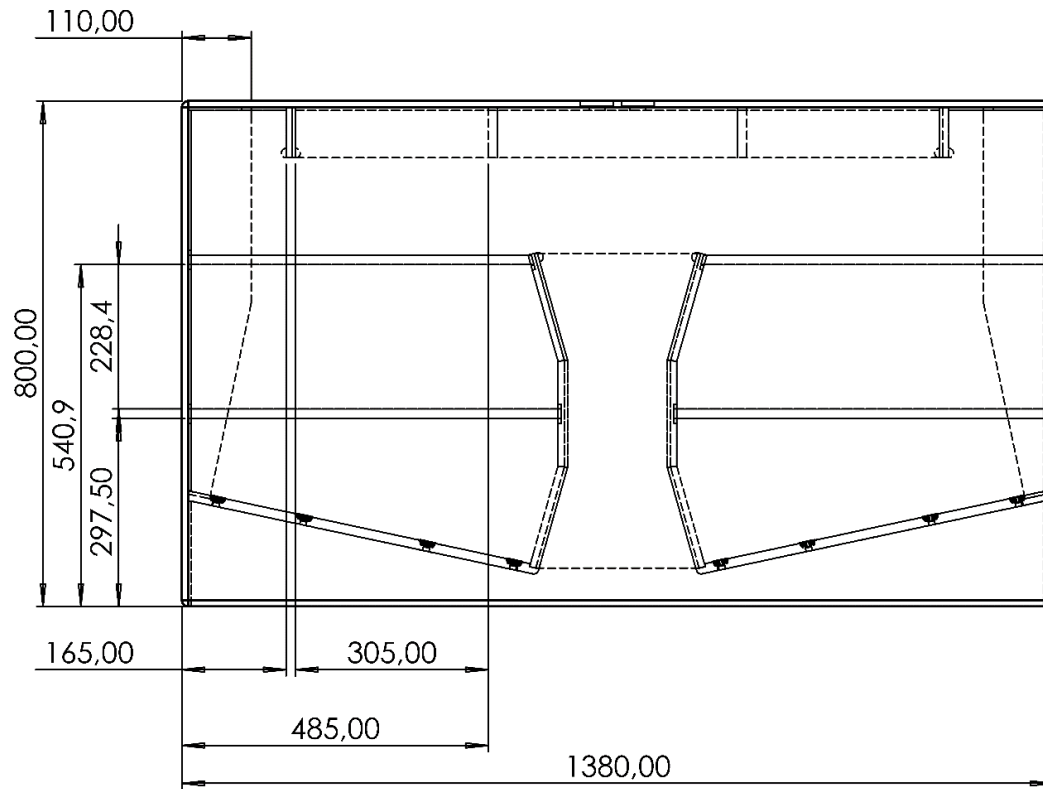



# S221 NTLW | DIMENSIONS

Front View

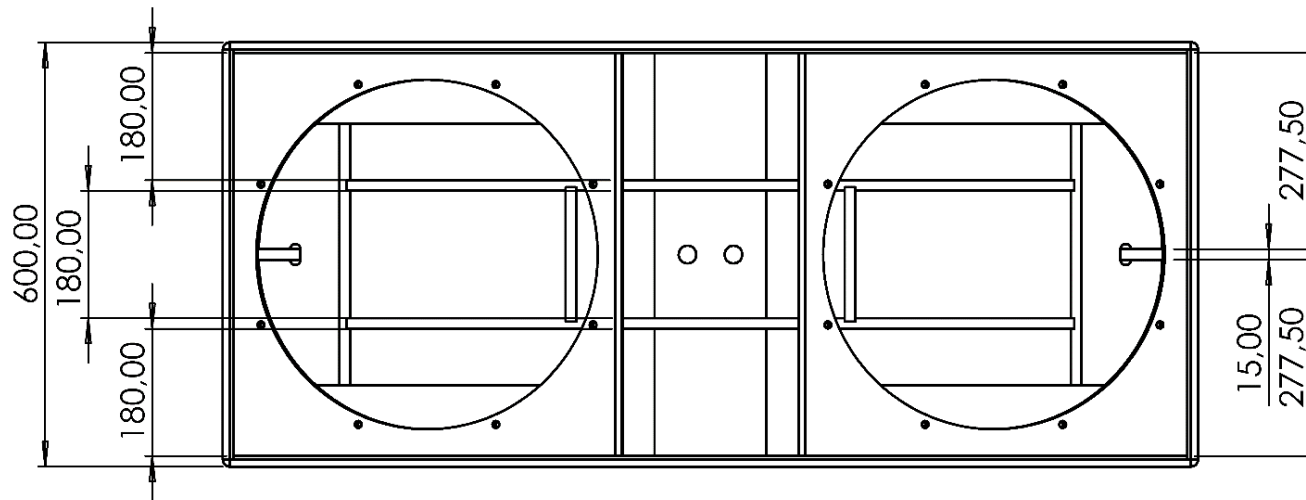



# S221 NTLW | DIMENSIONS

Back View

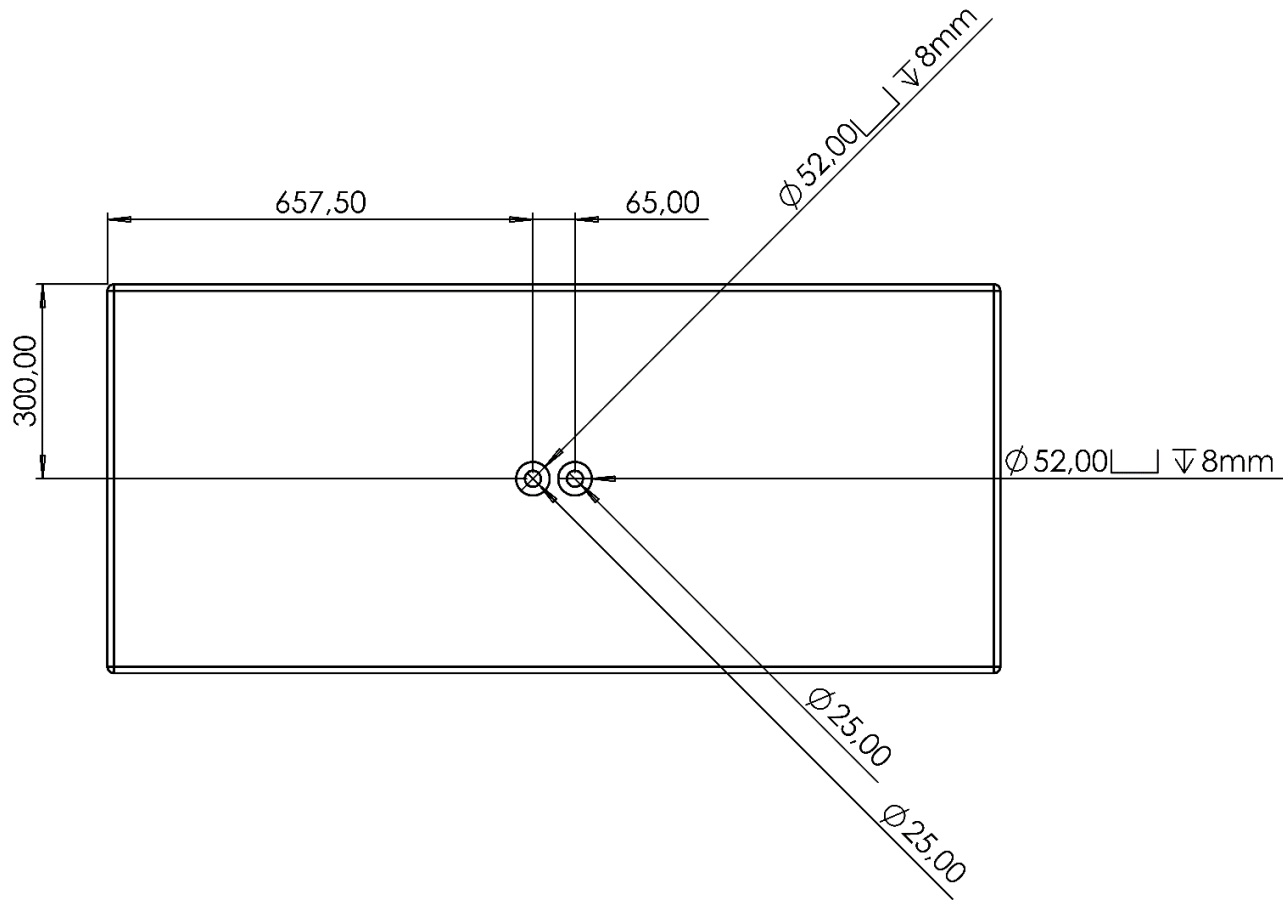



# S221 NTLW | DIMENSIONS

Back Reinforcement

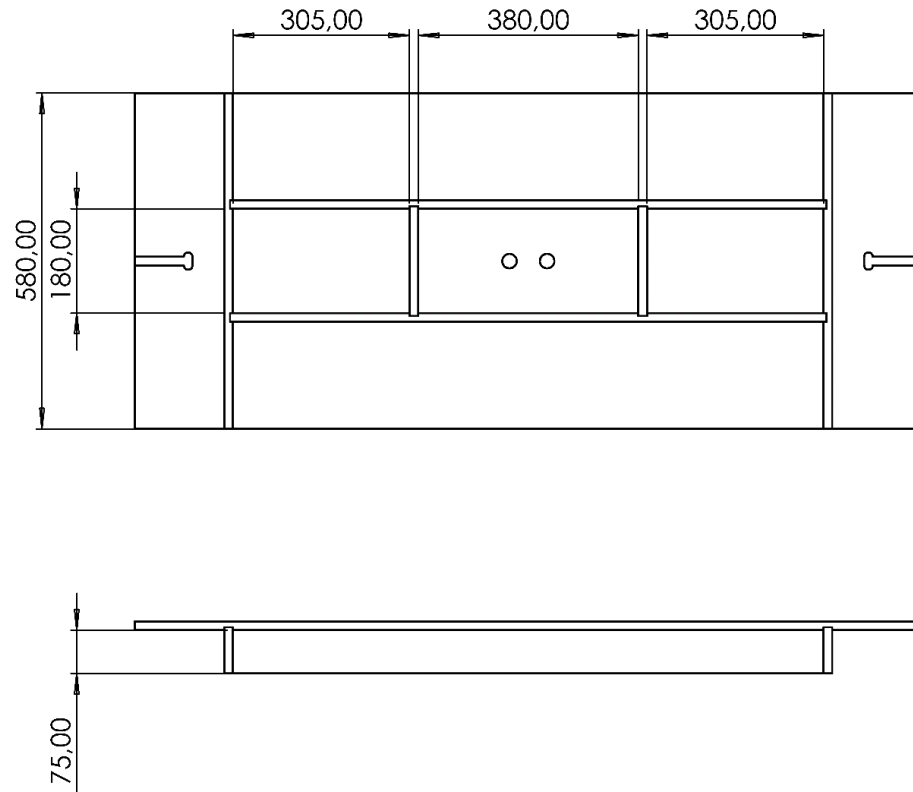



# S221 NTLW | DIMENSIONS

Baffle

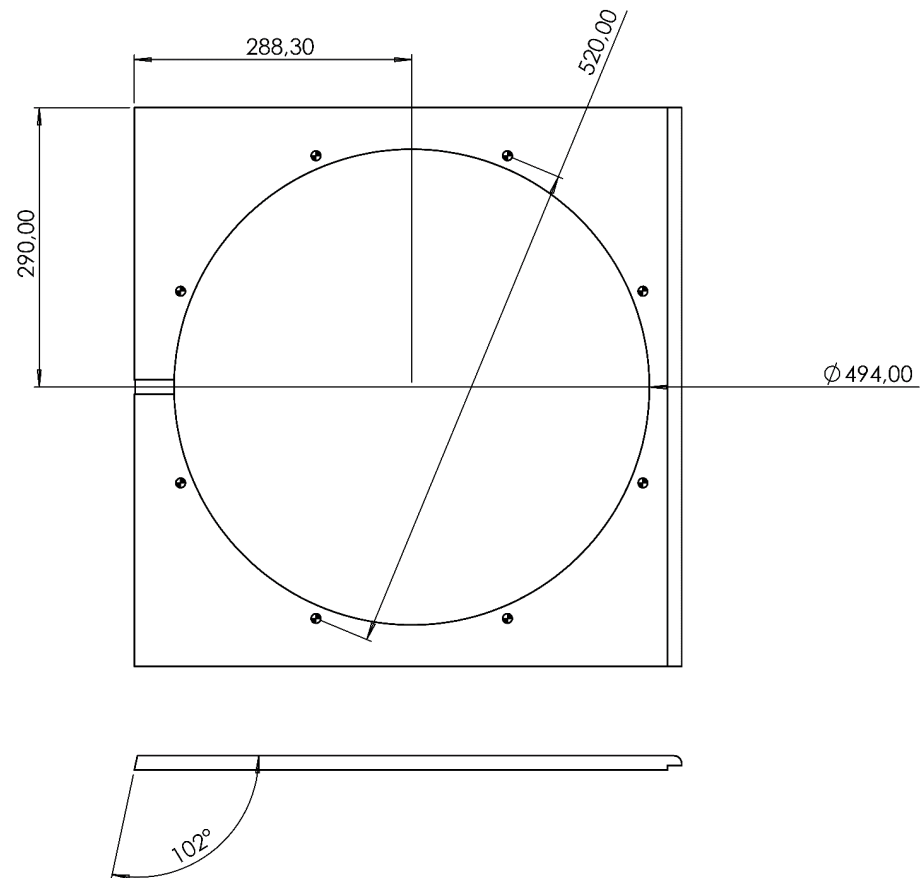





# **S221 NTLW** | NOTES